

NAME OF THE LAND OWNERS. :-
 1) SRI GURU CHARAN ROY.
 S/O. LATE ANANTA KUMAR ROY.
 AT SARAT NAGAR, SHIVMANDIR,
 P.O. NEW RANGIA, P.S. MATIGARA,
 DIST. DARJEELING.
 2) SRI SANTANU CHAKRABORTY.
 S/O. SRI SHIBATOSH CHAKRABORTY.
 AT MATRI ASHISH, PATEL ROAD,
 P.O. & P.S. PRADHAN NAGAR, DIST. DARJEELING.
NAME OF THE DEVELOPER. :-
 DARJEELING REAL ESTATE AGENT & DEVELOPER.
 OFFICE AT NEELKAMAL PLAZA, H.C. ROAD, SILIGURI,
 DIST. DARJEELING.
REPRESENTED BY ONE OF ITS PARTNER. :-
 SRI NISITH KUMAR AGARWAL.

LAND SCHEDULE. :-
 MOUZA. :- BAIRITTSAL.
 J.L. NO. :- 70
 P.S. :- MATIGARA.
 DIST. :- DARJEELING.

PART TRACE MAP OF MOUZA. BAIRITTSAL, J.L. NO. 70, P.S. MATIGARA,
 DIST. DARJEELING. SCALE :- 16" = 1 MILE,
 PROPOSED PLOT SHOWN.

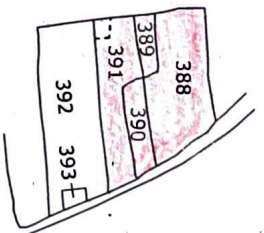

L.R. MAP

PART TRACE MAP OF MOUZA. BAIRITTSAL, J.L. NO. 70, P.S. MATIGARA,
 DIST. DARJEELING. SCALE :- 16" = 1 MILE,
 PROPOSED PLOT SHOWN.



R.S. MAP

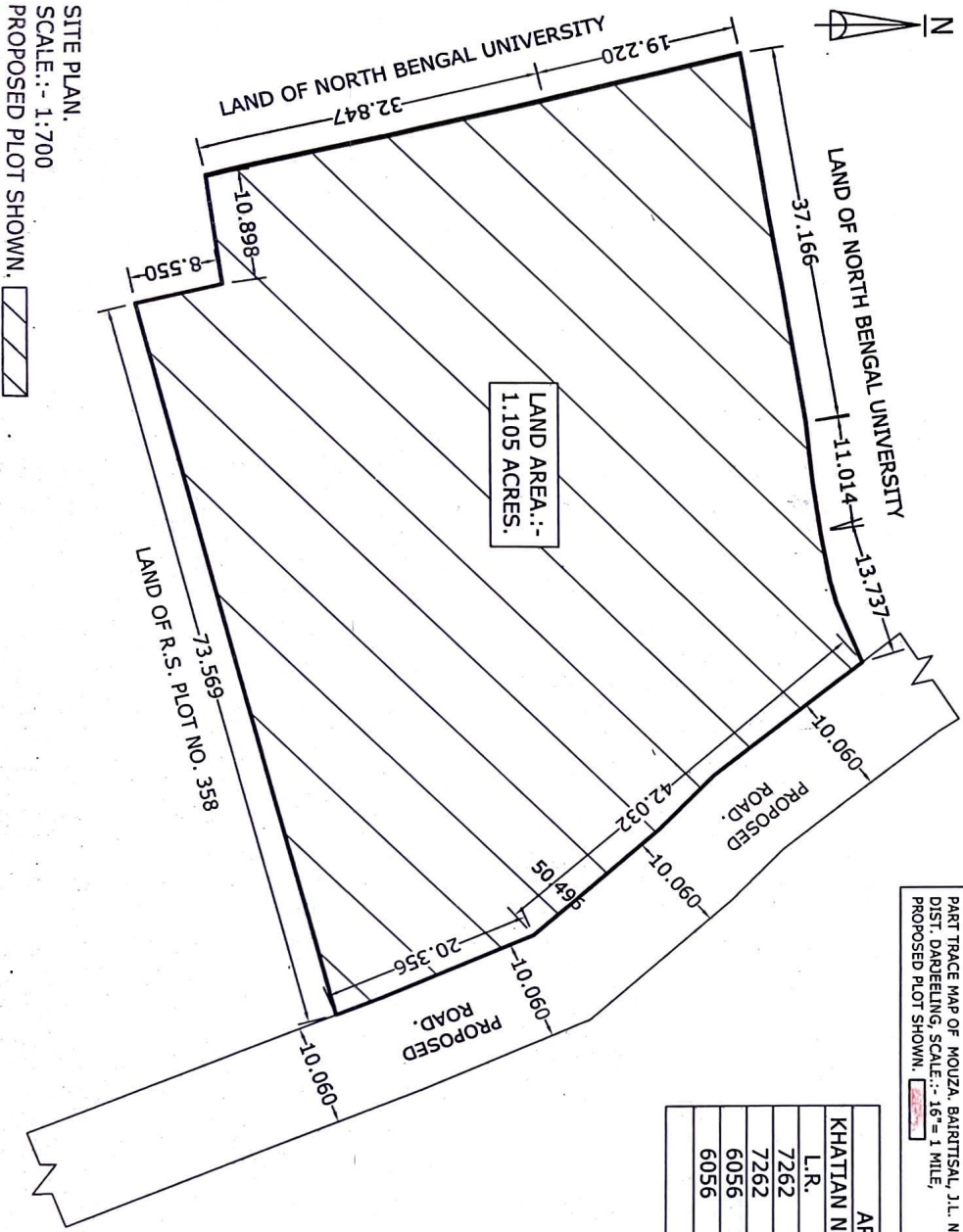

LAND AREA :-
 1.105 ACRES.

AREA STATEMENT :-				
KHATIAN NO.	PLOT NO.	L.R.	AREA IN ACRES.	
7262	351	388	0.525	
7262	357,355	391	0.330	
6056	354	389	0.080	
6056	356	390	0.170	
TOTAL AREA :-			1.105	

LAND AREA :- 1.105 ACRES.

Latitude - 26° 42'56.07" N
 Longitude - 88° 21'30.13" E

Darjeeling Real Estate Agents & Developers
Nisith Kumar Agarwal
Partner
As Constituted Attorney of
Santanu Chakraborty &
Gurucharan Roy.

SIGNATURE OF THE LAND OWNERS.
 DRAWN BY :-

M. Khatun
 Sivepriya
 Regd. No. 15414/1
 Bhashpally, Siliguri

SITE PLAN.
 SCALE :- 1:700
 PROPOSED PLOT SHOWN.